



Thrust ball bearings

POPULAR SIZE



ACCOR MACHINERY [BEARING] CO.,LTD

CAT.NO.2008JAN

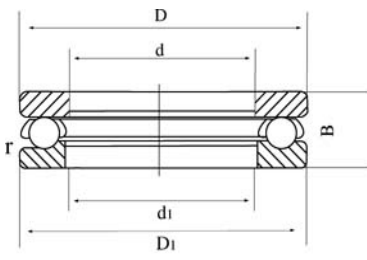

51100

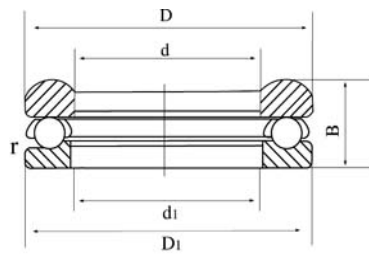

53100

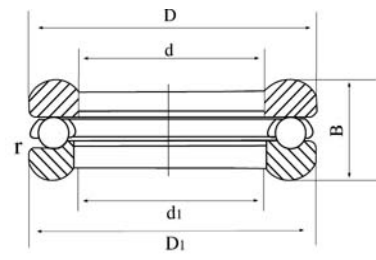

53100U

Bearing No.			Boundary Dimensions				Basic Load Ratings			Limiting Speed		Weight		
51000	53000	53000U	d mm	D mm	B mm	r min mm	Cr KN	Cor KN	Grease rpm	Oil rpm	51000 kg	53000 kg	53000U kg	
51100	53100	53100U	10	24	9	0.3	10	14	6500	10000	0.02			
51101	53101	53101U	12	26	9	0.3	10.3	15.4	6500	10000	0.022			
51102	53102	53102U	15	28	9	0.3	10.5	16.8	6100	9400	0.024			
51103	53103	53103U	17	30	9	0.3	10.5	18.2	6100	9400	0.028			
51104	53104	53104U	20	35	10	0.3	14.2	24.7	5100	7900	0.04			
51105	53105	53105U	25	42	11	0.6	19.5	37.2	4400	6800	0.059			
51106	53106	53106U	30	47	11	0.6	20.4	42.2	4300	6600	0.068			
51107	53107	53107U	35	52	12	0.6	20.4	44.7	3900	60000	0.09			
51108	53108	53108U	40	60	13	0.6	26.9	62.8	3400	5300	0.12			
51109	53109	53109U	45	65	14	0.6	27.8	69.1	3200	5000	0.15			
51110	53110	53110U	50	70	14	0.6	28.8	75.4	3100	4800	0.16			
51111	53111	53111U	55	78	16	0.6	34.8	93.1	2800	4300	0.24			
51112	53112	53112U	60	85	17	1	41.4	113	2600	4000	0.29			
51113	53113	53113U	65	90	18	1	41.7	117	2400	3700	0.34			
51114	53114	53114U	70	95	18	1	43	127	2300	3600	0.36			
51115	53115	53115U	75	100	19	1	42.3	127	2200	3400	0.42			
51116	53116	53116U	80	105	19	1	44.6	141	2100	3300	0.43			
51117	53117	53117U	85	110	19	1	45.9	150	2100	3200	0.46			
51118	53118	53118U	90	120	22	1	59.7	190	1900	2900	0.68			
51120	53120	53120U	100	135	25	1	85	268	1600	2500	0.99			
51122	53122	53122U	110	145	25	1	87.1	288	1600	2400	1.08			
51124	53124	53124U	120	155	25	1	89	308	1500	2300	1.16			
51126	53126	53126U	130	170	30	1	104	352	1300	20000	1.87			
51128	53128	53128U	140	180	31	1	107	377	1200	1900	2.02			
51130	53130	53130U	150	190	31	1	109	402	1200	1900	2.15			
51132	53132	53132U	160	200	31	1	112	427	1200	1800	2.28			
51200	53200	53200U	10	26	11	0.6	12.7	17.1	5700	8800	0.03	0.029	0.037	
51201	53201	53201U	12	28	11	0.6	13.2	19	5400	8300	0.034	0.031	0.043	

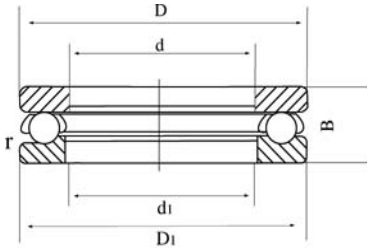

51200

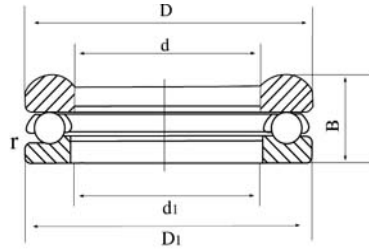

52200

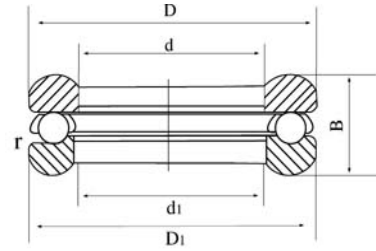

52200U

Bearing No.			Boundary Dimensions				Basic Load Ratings			Limiting Speed		Weight		
51000	53000	53000U	d	D	B	r min	Cr	Cor	Grease	Oil	51000	53000	53000U	
			mm	mm	mm	mm	KN	KN	rpm	rpm	kg	kg	kg	
51202	53202	53202U	15	32	12	0.6	16.6	24.8	4900	7500	0.046	0.048	0.062	
51203	53203	53203U	17	35	12	0.6	17.2	27.3	4900	7500	0.053	0.055	0.07	
51204	53204	53204U	20	40	14	0.6	22.3	37.7	3900	6000	0.082	0.08	0.1	
51205	53205	53205U	25	47	15	0.6	27.8	50.4	3600	5500	0.112	0.12	0.152	
51206	53206	53206U	30	52	16	0.6	29.3	58.2	3400	5200	0.15	0.16	0.193	
51207	53207	53207U	35	62	18	1	39.2	78.2	2900	4500	0.22	0.22	0.277	
51208	53208	53208U	40	68	19	1	46.9	98.3	2700	4200	0.27	0.27	0.34	
51209	53209	53209U	45	73	20	1	47.7	105	2600	4000	0.32	0.31	0.397	
51210	53210	53210U	50	78	22	1	48.5	111	2300	3600	0.39	0.38	0.48	
51211	53211	53211U	55	90	25	1	69.4	159	2100	3200	0.61	0.62	0.77	
51212	53212	53212U	60	95	26	1	73.4	179	1900	3000	0.69	0.69	0.85	
51213	53213	53213U	65	100	27	1	74.8	189	1900	2900	0.77	0.75	0.93	
51214	53214	53214U	70	105	27	1	73.6	189	1800	2800	0.81	0.8	0.99	
51215	53215	53215U	75	110	27	1	77.4	209	1800	2700	0.86	0.85	1.06	
51216	53216	53216U	80	115	28	1	78.5	218	1700	2600	0.95	0.93	1.15	
51217	53217	53217U	85	125	31	1	92.3	251	1500	2300	1.29	1.28	1.57	
51218	53218	53218U	90	135	35	1.1	117	326	1400	2100	1.77	1.77	2.19	
51220	53220	53220U	100	150	38	1.1	147	410	1200	1900	2.36	2.34	2.84	
51222	53222	53222U	110	160	38	1.1	148	431	1200	1800	2.57	2.5	3.06	
51224	53224	53224U	120	170	39	1.1	154	472	1100	1700	2.86	2.81	3.46	
51226	53226	53226U	130	190	45	1.5	203	622	970	1500	4.09	3.98	4.88	
51228	53228	53228U	140	200	46	1.5	215	669	940	1450	4.46	4.35	5.89	
51230	53230	53230U	150	215	50	1.5	244	768	840	1300	5.64	5.45	7.14	
51232	53232	53232U	160	225	51	1.5	247	803	810	1250	6.53	6.09	7.9	
51305	53305	53305U	25	52	18	1	35.7	61.4	3100	4800	0.018	0.18	0.224	
51306	53306	53306U	30	60	21	1	42.8	78.7	2700	4200	0.27	0.27	0.326	
51307	53307	53307U	35	68	24	1	55.5	105	2400	3700	0.39	0.4	0.484	
51308	53308	53308U	40	78	26	1	69.3	135	2100	3300	0.55	0.57	0.69	
51309	53309	53309U	45	85	28	1	80	163	1900	3000	0.69	0.68	0.85	
51310	53310	53310U	50	95	31	1.1	91.6	186	1800	2700	1	1.01	1.24	
51311	53311	53311U	55	105	35	1.1	119	246	1600	2400	1.34	1.41	1.69	
51312	53312	53312U	60	110	35	1.1	124	267	1500	2300	1.43	1.47	1.78	

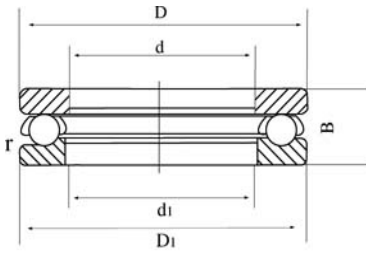

51300

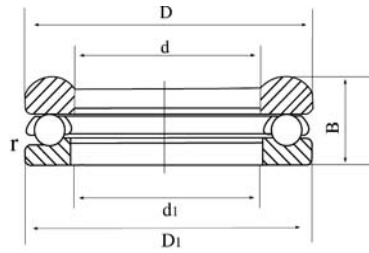

53300

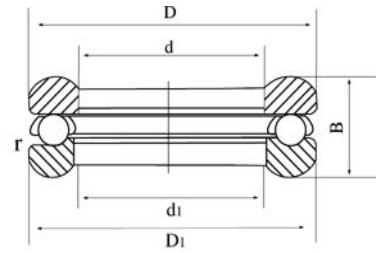

53300U

Bearing No.			Boundary Dimensions				Basic Load Ratings		Limiting Speed		Weight		
51000	53000	53000U	d mm	D mm	B mm	r min mm	Cr KN	Cor KN	Grease rpm	Oil rpm	51000 kg	53000 kg	53000U kg
51313	53313	53313U	65	115	36	1.1	128	287	1400	2200	1.57	1.61	1.95
51314	53314	53314U	70	125	40	1.1	148	339	1300	1000	2.06	2.15	2.56
51315	53315	53315U	75	135	44	1.5	171	396	1200	1900	2.68	2.72	3.27
51316	53316	53316U	80	140	44	1.5	176	424	1200	1800	2.82	2.86	3.43
51317	53317	53317U	85	150	49	1.5	206	189	1100	1700	3.66	3.63	4.44
51318	53318	53318U	90	155	50	1.5	213	524	1000	1600	3.88	3.87	4.71
51320	53320	53320U	100	170	55	1.5	236	596	940	1450	5.11	5.1	6.05
51322	53322	53322U	110	190	63	2	280	754	810	1250	7.72	7.63	8.9
51324	53324	53324U	120	210	70	2.1	325	931	710	1100	10.6	10.4	12.4
51326	53326	53326U	130	225	75	2.1	346	1030	650	1000	13	12.7	15.2
51328	53328	53328U	140	240	80	2.1	367	1130	620	950	15.5	15.1	18
51330	53330	53330U	150	250	80	2.1	377	1200	580	900	16.3	15.7	18.8
51332	53332	53332U	160	270	87	3	470	1570	550	850	21	21	23.4
51405	53405	53405U	25	60	24	1	55.6	89.4	2600	4000	0.34	0.35	0.442
51406	53406	53406U	30	70	28	1	72.8	126	2200	3400	0.53	0.53	0.66
51407	53407	53407U	35	80	32	1.1	87.1	155	1900	2900	0.79	0.79	0.96
51408	53408	53408U	40	90	36	1.1	113	205	1700	2600	1.14	1.12	1.37
51409	53409	53409U	45	100	39	1.1	130	242	1500	2300	1.47	1.5	1.82
51410	53410	53410U	50	110	43	1.5	148	283	1400	2100	1.99	1.97	2.38
51411	53411	53411U	55	120	48	1.5	178	359	1200	1900	2.64	2.57	3.1
51412	53412	53412U	60	130	51	1.5	201	397	1100	1700	3.51	3.44	4.13
51413	53413	53413U	65	140	56	2	232	493	1000	1600	4.47	4.47	5.28
51414	53414	53414U	70	150	60	2	250	553	940	1450	5.48	5.38	6.37
51415	53415	53415U	75	160	65	2	252	560	880	1350	6.75	6.64	7.87
51416	53416	53416U	80	170	68	2.1	270	621	810	1250	7.97	7.84	9.22
51417	53417	53417U	85	180	72	2.1	307	753	780	1200	9.29	9.2	10.8

Notes:

51000 - Plain Housing washer Type

53100 - Spherical Housing washer Type

53100U - With spherical seating washer

52000 - Double direction thrust ball bearings. It is available.

54100 - Spherical Housing washer Type

54100U - With spherical seating washer



Ningbo Accor Machinery (Bearings) Co Ltd

Add: 4F, 675 Shiji Avenue, Jiangdong, Ningbo 315040, China

Ph: +86 574 87939850, 87939855

Fax: +86 574 87939860

E-mail: accor@accormachinery.com.cn

[http:// www.accorbearings.com](http://www.accorbearings.com) , www.accormachinery.com