

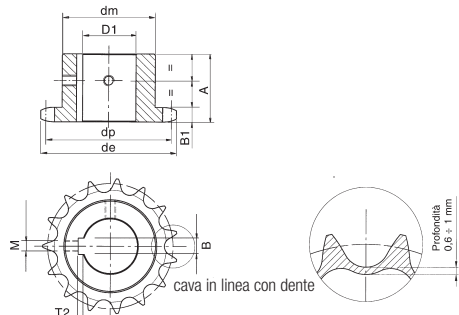

PIGNONI SEMPLICI CON DENTI TEMPRATI AD INDUZIONE CON FORO + CAVA + FORI VITE

3/8" x 7/32" 06B-1

per catene a rulli secondo
DIN 8187 - ISO/R 606



Denti temprati ad induzione HRC 45 ÷ 53

PIGNONE

LARGHEZZA DENTE PIGNONE B_1 5.3 mm

CATENA

PASSO 9.525 mm

LARGHEZZA INTERNA 5.72 mm

RULLO \emptyset 6.35 mm

MATERIALE: C 45 UNI 7845

Z	d_e	d_p	d_m	A	D_1	Z	d_e	d_p	d_m	A	D_1	Z	d_e	d_p	d_m	A	D_1
12	40.45	36.80	25	25	12	18	58.3	54.85	43	28	14	23	73.7	69.95	52	28	15
			29		14						15						16
			30		15						16						18
			31		16						18						19
					18						19						20
					18						20						22
					18						22						24
					18						24						25
13	43.5	39.80	28	25	12	19	61.6	57.87	45	28	15	24	76.7	72.97	54	28	18
					14						16						19
					15						18						20
					16						19						22
					18						20						24
					18						22						25
					18						24						28
					18						25						30
14	46.5	42.80	31	25	12	20	64.3	60.89	46	28	15	25	79.7	76.00	57	28	18
					14						16						20
					15						18						22
					16						19						24
					18						20						25
					18						22						28
					18						24						30
15	49.5	45.81	34	25	14	21	67.6	63.91	48	28	15	27	85.7	82.05	60	28	20
					15						16						22
					16						18						24
					18						19						25
					18						20						28
					18						22						30
					18						24						30
16	52.3	48.82	37	28	14	22	70.9	67.01	50	28	16	29	91.8	88.01	72	28	20
					15						18						22
					16						20						24
					18						22						25
					18						24						28
					18						25						30
					18						28						30
					18						30						30
17	55.5	51.83	40	28	14	23	73.8	70.01	52	28	17	30	94.8	91.12	60	30	20
					15						18						22
					16						20						24
					18						22						25
					18						24						28
					18						25						30
					18						28						30
					18						30						30
					18						32						30
					18						35						30
					18						38						30

1/2" x 5/16" 08B-1

per catene a rulli secondo
DIN 8187 - ISO/R 606

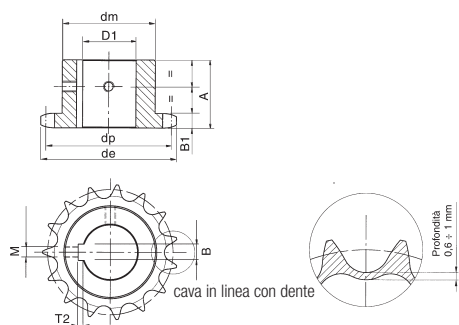

Denti temprati ad induzione HRC 45 ÷ 53

PIGNONE

LARGHEZZA DENTE PIGNONE B_1 7.2 mm

CATENA

PASSO 12.7 mm

LARGHEZZA INTERNA 7.75 mm

RULLO \emptyset 8.51 mm

MATERIALE: C 45 UNI 7845

Z	d_e	d_p	d_m	A	D_1	Z	d_e	d_p	d_m	A	D_1	Z	d_e	d_p	d_m	A	D_1
12	53.9	49.07	33	28	12	17	74	69.11	52	28	15	23	98.1	93.27	70	28	20
					14						16						22
					15						18						24
					16						20						25
					18						22						28
					19						24						30
					20						25						32
					20						28						35
					20						30						38
					20						32						38
					20						35						38
13	57.9	53.06	37	28	12	18	77.8	73.14	56	28	16	24	102.1	97.29	70	28	20
					14						18						22
					15						20						24
					16						22						25
					18						24						28
					18						25						30
					18						28						32
					18						30						35
					18						32						38
					18						35						38
14	61.6	57.07	41	28	14	19	82	77.16	60	28	17	25	105.8	101.33	70	28	20
					15						19						22
					16						20						24
					18						22						25
					18						24						28
					18						25						30
					18						28						32
					18						30						35
					18						32						38
					18						35						38
15	65.9	61.09	45	28	14	20	85.8	81.19	64	28	19	27	114	109.4	70	30	22
					15						20						25
					16						22						28
					18						24						30
					18						25						32
					18						28						35
					18						30						38
					18						32						38
					18						35						38
16	69.5	65.1	50	28	15	21	90.1	85.22	68	28	20	30	126.3	121.5	80	30	25
					16						19						28
					18						20						30
					18						22						32
					19						24						35
					20						25						38
					22						28						38
					24						30						38
					24						32						38
					24						35						38
					24						38						38



PIGNONI SEMPLICI CON DENTI TEMPRATI AD INDUZIONE CON FORO + CAVA + FORI VITE

5/8" x 3/8" 10B-1

per catene a rulli secondo
DIN 8187 - ISO/R 606

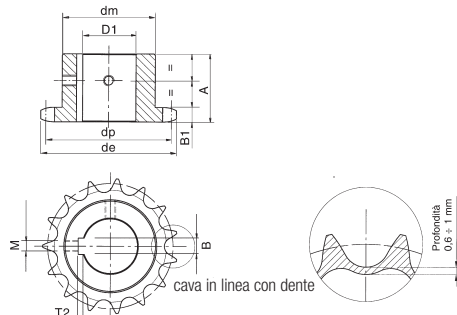

Denti temprati ad induzione HRC 45 ÷ 53

PIGNONE

LARGHEZZA DENTE PIGNONE B_1 9.1 mm

CATENA

PASSO 15.875 mm
LARGHEZZA INTERNA 9.65 mm
RULLO Ø 10.16 mm

MATERIALE: C 45 UNI 7845

Z	d _e	d _p	d _m	A	D ₁	Z	d _e	d _p	d _m	A	D ₁	Z	d _e	d _p	d _m	A	D ₁
12	68.2	61.34	42	30	16	17	93.2	86.39	60	30	20	21	113.4	106.52	75	30	20
					19						22						22
					20						24						24
					22						25						25
					24						28						28
					25						30						30
					28						32						32
					28						35						35
					30						38						38
					30						40						40
13	73.2	66.32	47	30	16	18	98.3	91.42	70	30	20	23	123.4	116.58	80	30	20
					19						22						22
					20						24						24
					22						25						25
					24						28						28
					25						30						30
					28						32						32
					28						35						35
					30						38						38
					30						40						40
14	78.2	71.34	52	30	16	19	103.3	96.45	70	30	20	24	128.5	121.62	80	30	20
					19						22						22
					20						24						24
					22						25						25
					24						28						28
					25						30						30
					28						32						32
					28						35						35
					30						38						38
					30						40						40
15	83.2	76.36	57	30	19	20	108.4	101.49	75	30	20	25	133.5	126.66	80	30	22
					20						22						24
					22						24						25
					24						25						28
					25						28						30
					28						30						32
					28						32						35
					30						35						38
					30						40						40
16	88	81.37	60	30	20	20					22	25					22
					22						24						25
					24						25						28
					25						28						30
					28						30						32
					28						32						35
					30						35						38
					30						40						40
					35												42

3/4" x 7/16" 12B-1

per catene a rulli secondo
DIN 8187 - ISO/R 606

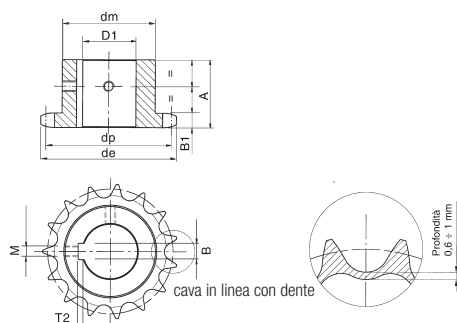

Denti temprati ad induzione HRC 45 ÷ 53

PIGNONE

LARGHEZZA DENTE PIGNONE B_1 11.1 mm

CATENA

PASSO 19.05 mm
LARGHEZZA INTERNA 11.68 mm
RULLO Ø 12.07 mm

MATERIALE: C 45 UNI 7845

Z	d _e	d _p	d _m	A	D ₁	Z	d _e	d _p	d _m	A	D ₁	Z	d _e	d _p	d _m	A	D ₁
12	81.8	73.6	52	35	20	17	111.2	103.67	80	35	22	23	147.4	139.90	90	40	28
					22						25						30
					24						28						32
					25						30						35
					28						32						38
					28						35						40
					30						38						42
					30						40						45
13	87.1	79.60	58	35	20	18	118.0	109.71	80	35	22	24	154.1	145.94	90	40	28
					22						25						30
					24						28						32
					25						30						35
					28						32						38
					28						35						40
					30						38						42
					30						40						45
14	93.8	85.61	64	35	20	19	123.3	115.75	80	35	25	25	159.5	152.00	90	40	28
					22						28						30
					24						30						32
					25						32						35
					28						35						38
					28						38						40
					30						40						42
					30						45						45
15	99.2	91.63	70	35	20	20	129.7	121.78	80	35	25	25					28
					22						28						30
					24						30						32
					25						32						35
					28						35						38
					28						38						40
					30						40						42
					30						45						45
16	105.5	97.65	75	35	20	21	135.4	127.82	90	40	28						28
					22						30						30
					25						32						32
					28						35						35
					28						38						38
					30						40						40
					30						42						42
					35						45						45
					38						48						48
					40						50						50



PIGNONI SEMPLICI CON DENTI TEMPRATI AD INDUZIONE CON FORO + CAVA + FORI VITE

1" x 17.02 16B-1

per catene a rulli secondo
DIN 8187 - ISO/R 606

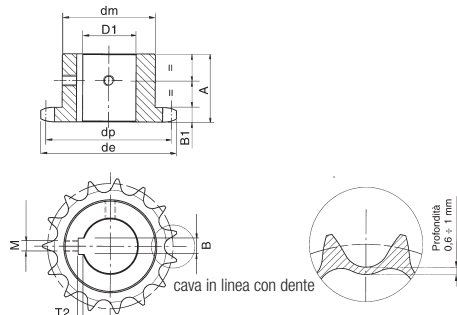

Denti temprati ad induzione HRC 45 ÷ 53

PIGNONE

LARGHEZZA DENTE PIGNONE B₁ 16.2 mm

CATENA

PASSO 25.4 mm
LARGHEZZA INTERNA 17.02 mm
RULLO Ø 15.88 mm

MATERIALE: C 45 UNI 7845

Z	d _e	d _p	d _m	A	D ₁	Z	d _e	d _p	d _m	A	D ₁	Z	d _e	d _p	d _m	A	D ₁
12	109.71	98.14	69	40	25	16	141.0	130.20	100	45	30	20	173.2	162.38	100	45	30
					28						32						32
					30						35						35
					32						38						38
					35						40						40
					38						42						42
					40						45						45
					42						48						48
					45						50						50
					48												
					50												
13	117.2	106.14	78	40	25	17	149.4	138.22	100	45	30	21	181.6	170.43	110	50	30
					28						32						32
					30						35						35
					32						38						38
					35						40						40
					38						42						42
					40						45						45
					42						48						48
					45						50						50
					48												
					50												
14	125.7	114.15	84	40	25	18	157.0	146.28	100	45	30	23	198.1	186.1	110	50	30
					28						32						32
					30						35						35
					32						38						38
					35						40						40
					38						42						42
					40						45						45
					42						48						48
					45						50						50
					48												
					50												
15	133.3	122.17	92	40	28	19	165.5	154.33	100	45	30	25	214.2	202.66	110	50	30
					30						32						32
					32						35						35
					35						38						38
					38						40						40
					40						42						42
					42						45						45
					45						48						48
					48						50						50
					50												

Cave DIN 6885 - UNI 6604

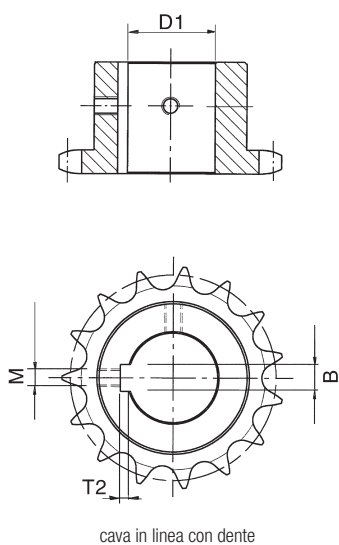

D ₁ Foro	B Larghezza cava	T ₂ Profondità cava	M Viti
Ø 12 H7 +0.018/-0	4 H9 +0.030/-0	1,8 +0.10/-0	M4
Ø 14 H7 +0.018/-0	5 H9 +0.030/-0	2,3 +0.10/-0	M4
Ø 15 H7 +0.018/-0	5 H9 +0.030/-0	2,3 +0.10/-0	M4
Ø 16 H7 +0.018/-0	5 H9 +0.030/-0	2,3 +0.10/-0	M4
Ø 18 H7 +0.018/-0	6 H9 +0.030/-0	2,8 +0.10/-0	M5
Ø 19 H7 +0.021/-0	6 H9 +0.030/-0	2,8 +0.10/-0	M5
Ø 20 H7 +0.021/-0	6 H9 +0.030/-0	2,8 +0.10/-0	M5
Ø 22 H7 +0.021/-0	6 H9 +0.030/-0	2,8 +0.10/-0	M5
Ø 24 H7 +0.021/-0	8 H9 +0.036/-0	3,3 +0.20/-0	M6
Ø 25 H7 +0.021/-0	8 H9 +0.036/-0	3,3 +0.20/-0	M6
Ø 28 H7 +0.021/-0	8 H9 +0.036/-0	3,3 +0.20/-0	M6
Ø 30 H7 +0.021/-0	8 H9 +0.036/-0	3,3 +0.20/-0	M6
Ø 32 H7 +0.025/-0	10 H9 +0.036/-0	3,3 +0.20/-0	M8
Ø 35 H7 +0.025/-0	10 H9 +0.036/-0	3,3 +0.20/-0	M8
Ø 38 H7 +0.025/-0	10 H9 +0.036/-0	3,3 +0.20/-0	M8
Ø 40 H7 +0.025/-0	12 H9 +0.043/-0	3,3 +0.20/-0	M10
Ø 42 H7 +0.025/-0	12 H9 +0.043/-0	3,3 +0.20/-0	M10
Ø 45 H7 +0.025/-0	14 H9 +0.043/-0	3,8 +0.20/-0	M12
Ø 48 H7 +0.025/-0	14 H9 +0.043/-0	3,8 +0.20/-0	M12
Ø 50 H7 +0.025/-0	14 H9 +0.043/-0	3,8 +0.20/-0	M12